

AXESS

35001010400 Grab bar

PRODUCT

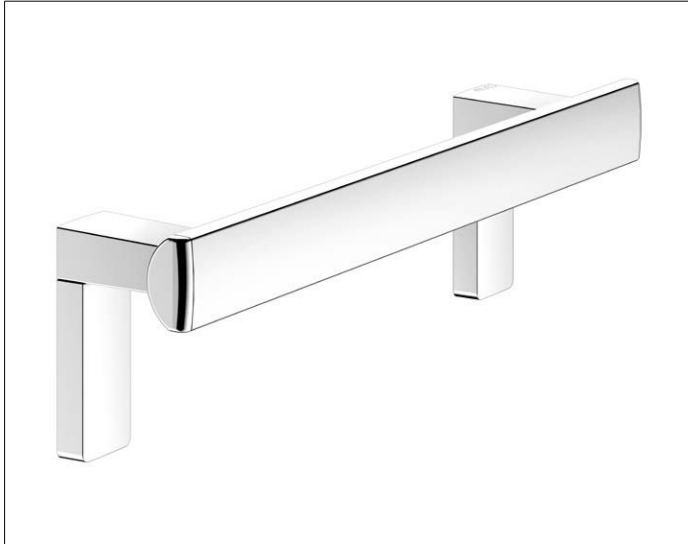

DRAWING

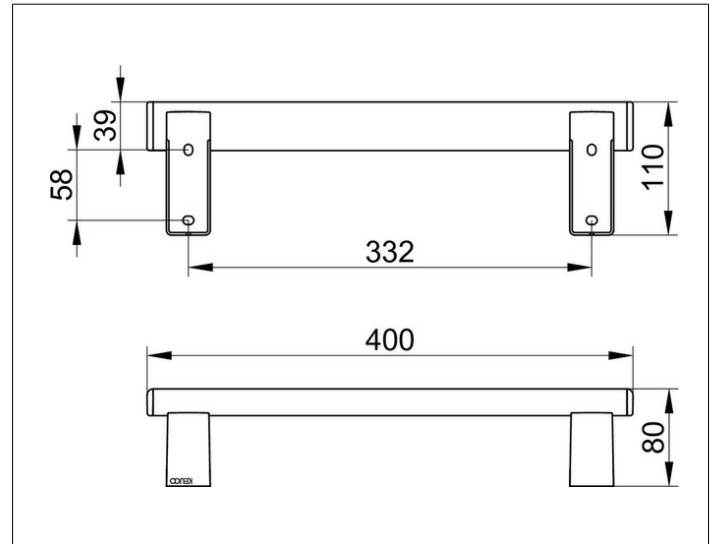

PRODUCT ATTRIBUTES

for horizontal or vertical installation

SURFACE

chrome-plated

DIMENSION

400 mm

SPECIFICATIONS

KEUCO AXESS - Grab bar 400mm - 350 01 010400

Accessibility meets design

Grab bar for vertical or horizontal mounting. high gripping comfort front flat back formed as half circle. Strong mounting is in aesthetic and functional harmony. The product is screwed on. Two concealed fastening.

Width / ø : 400 mm - Height: 110 mm - Depth: 80 mm

Material: Metal

Surface: Chrome-plated

Load capacity 115 kg

Included in delivery 2x mounting sets no 1.

Article no.: 350 01 010400