

## Shower and shower accessories

### 51689010300 Arm for head shower DN 15

#### PRODUCT



#### PRODUCT ATTRIBUTES

ceiling mounted G 1/2, with round decorative disc  
 Opportunity of alignment to the ceiling ( $90^\circ \pm 2^\circ$ ) and  
 ceiling connection ( $90^\circ \pm 5^\circ$ )

#### SURFACE

chrome-plated

#### DIMENSION

300 mm

#### DRAWING

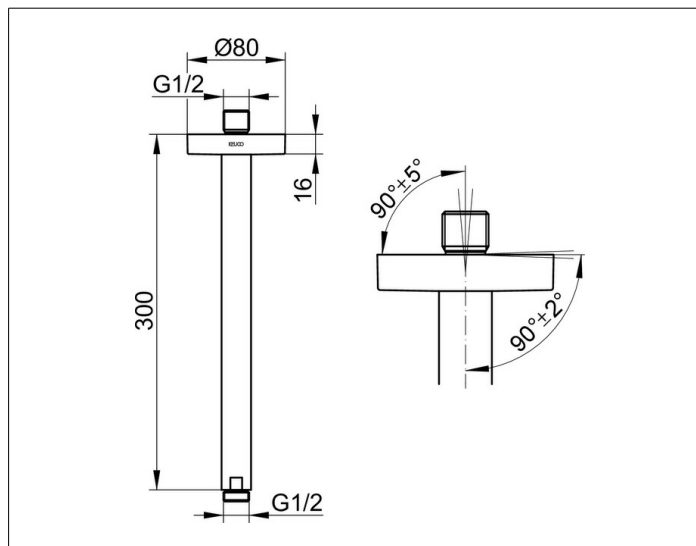

#### SPECIFICATIONS

KEUCO ELEGANCE Shower holder for ceiling 51689010300  
 chrome plated shower holder for ceiling,  
 G 1/2 inch, with round wall element, diameter 60 mm,  
 Projection: 300 mm