

## Shower and shower accessories

### 53089010302 Arm for head shower DN 15

#### PRODUCT



#### PRODUCT ATTRIBUTES

ceiling mounted G 1/2, with square decorative disc  
 Opportunity of alignment on the ceiling ( $90^\circ \pm 2^\circ$ ) and  
 ceiling connection ( $90^\circ \pm 5^\circ$ )

#### SURFACE

chrome-plated

#### DIMENSION

300 mm

#### DRAWING

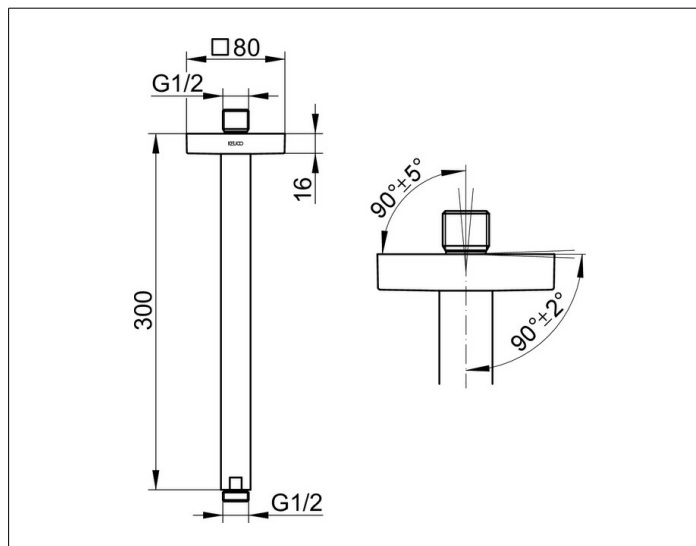

#### SPECIFICATIONS

KEUCO EDITION 300 shower arm for ceiling connection 53089010302  
 High-gloss chrome plated shower arm for wall connection  
 Elegant style,  
 Total extension 300 mm  
 Water connection G 1 / 2